

## Outlook 102

Outlook 102 features two exterior entrances, two interior entrances and abundant windows. Located adjacent to Outlook 101, this space is equipped with a large wall-mounted TV for presentations and serves as an ideal breakout room for Outlook 101 or a team meeting in a light and airy environment. Meeting spaces in Outlook are conveniently located alongside the campus common area — steps away from Common Grounds Café, Joanie's Garden and Teaching Kitchen, and outdoor patios with fire pits for gathering between sessions.

## Dimensions & Details

Dimensions (L x W)	Square Feet	Theatre	Classroom	Round (8 per table)	Yoga	Meditation
25' x 50'	1,250	95	72	70	25	33



## Additional Features

A variation of tables, chairs and props is available. Our production staff will work with your group to accommodate all setup needs. Please inquire about our full list of AV capabilities and technical support staff. *Please note that above rendering is not to scale.*

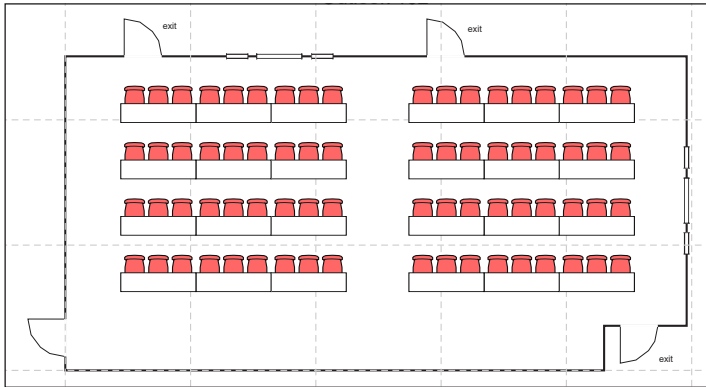

**Outlook 102 | Classroom**

72 Seats, 24 Tables

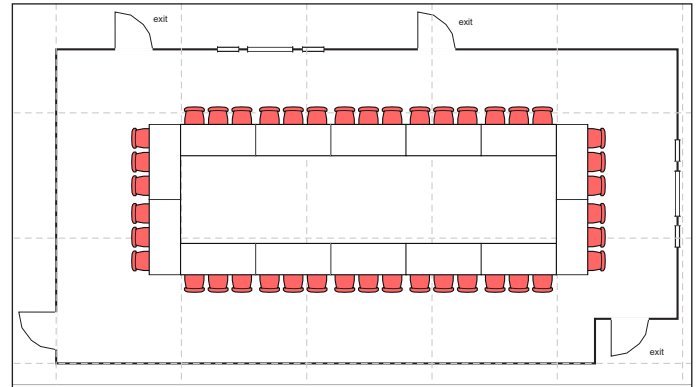

**Outlook 102 | Hollow Square**

42 Seats, 14 Tables

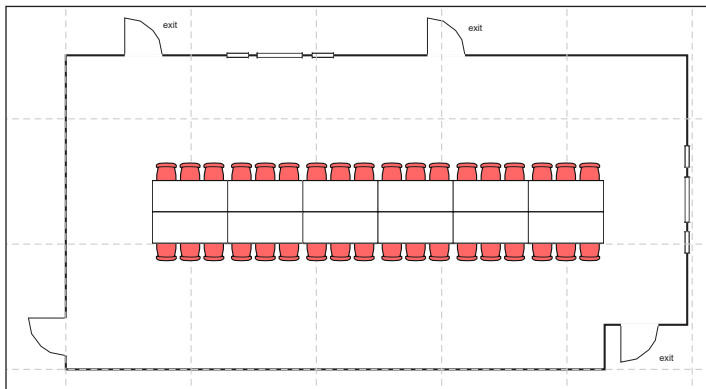

**Outlook 102 | Conference**

36 Seats, 12 Tables

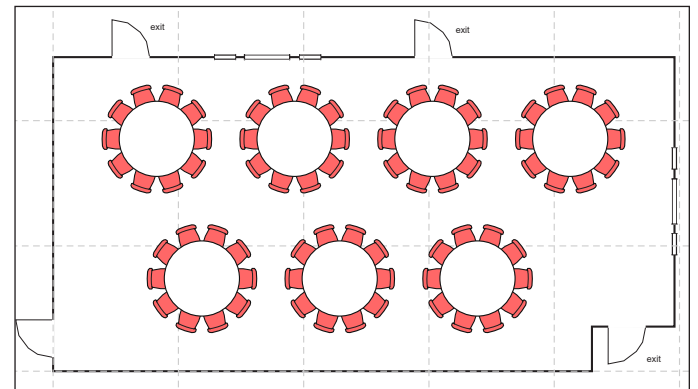

**Outlook 102 | Rounds**

70 Seats, 7 Tables

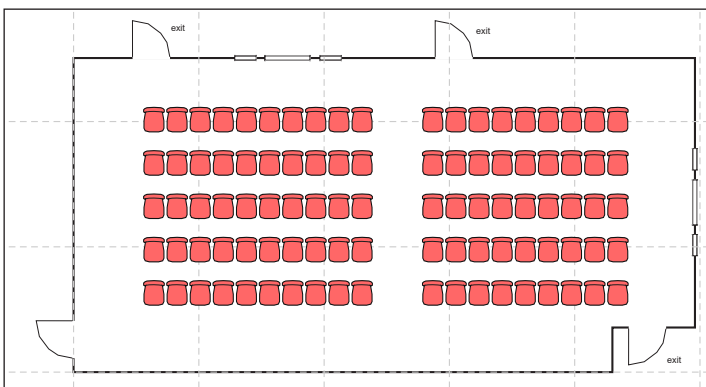

**Outlook 102 | Theatre**

95 Seats, 0 Tables

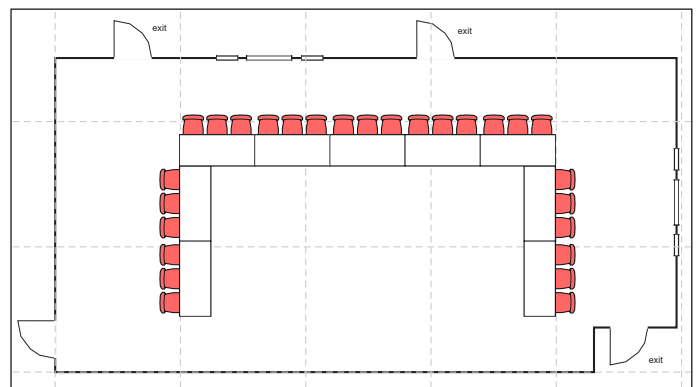

**Outlook 102 | U Shape**

27 Seats, 9 Tables

**Please Note:** Diagrams are for illustrative purposes only. Standard sets include theatre only; in most cases custom sets, tables and linens are an additional charge. Please refer to the Meeting Space Design Inventory list for in-house items available and contact the 1440 Program Planning and Events Teams for more information.