

Outlook 103

Outlook 103 is positioned steps away from Outlook 101 and 102, and is equipped with a large wall-mounted TV for presentations. This space functions well as a small group teambuilding or breakout location for focused work. Meeting spaces in Outlook are conveniently located alongside the campus common area — steps away from Common Grounds Café, Joanie's Garden and Teaching Kitchen, and outdoor patios with fire pits for gathering between sessions.

Dimensions & Details

Dimensions (L x W)	Square Feet	Theatre	Classroom	Round (8 per table)	Yoga	Meditation
25' x 22'	550	35	27	32	15	20

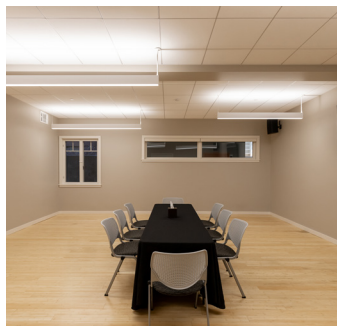

Additional Features

A variation of tables, chairs and props is available. Our production staff will work with your group to accommodate all setup needs. Please inquire about our full list of AV capabilities and technical support staff. *Please note that above rendering is not to scale.*

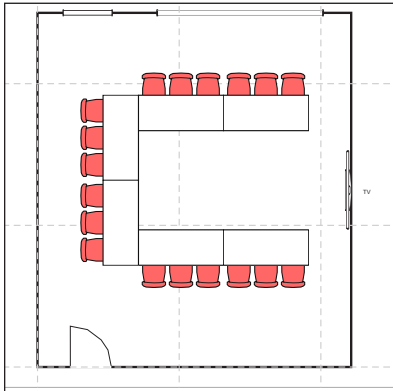

Outlook 103 | U Shape

18 Seats, 6 Tables

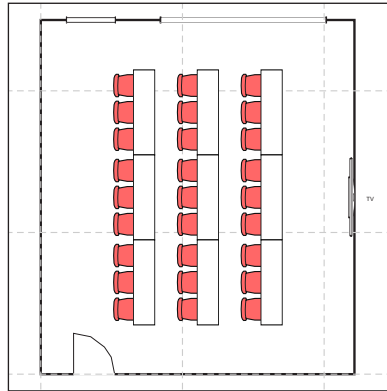

Outlook 103 | Classroom

27 Seats, 9 Tables

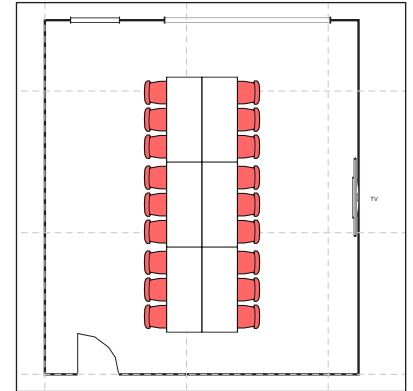

Outlook 103 | Conference

18 Seats, 6 Tables

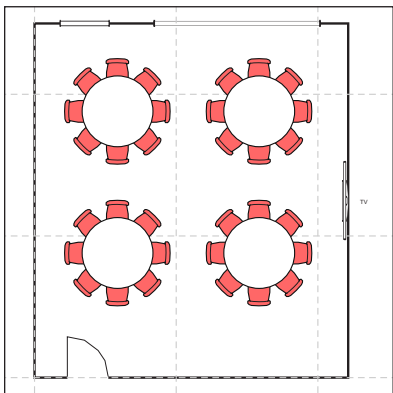

Outlook 103 | Rounds

32 Seats, 4 Tables

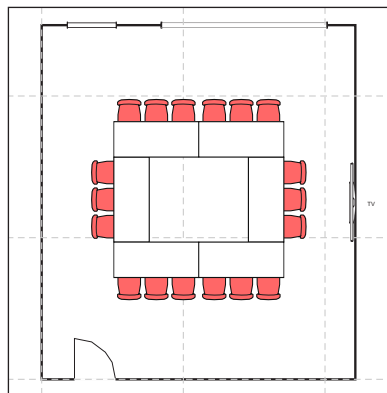

Outlook 103 | Hollow Square

18 Seats, 6 Tables

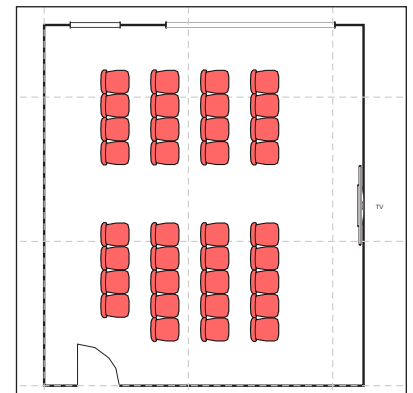

Outlook 103 | Theatre

35 Seats, 0 Tables

Please Note: Diagrams are for illustrative purposes only. Standard sets include theatre only; in most cases custom sets, tables and linens are an additional charge. Please refer to the Meeting Space Design Inventory list for in-house items available and contact the 1440 Program Planning and Events Teams for more information.